

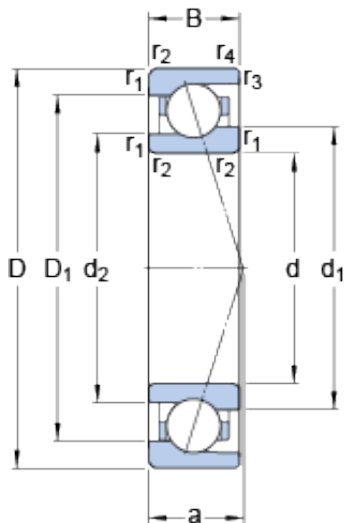

UNF BRAINGS SALES JAPAN CO.,LTD.



71902 ACE/P4A Bearing 2D drawings and 3D CAD models

15 mm x 28 mm x 7 mm SKF 71902 ACE/P4A High Accuracy Precision Bearings

Bearing No. 71902 ACE/P4A

Size	28x15x7 mm
Bore Diameter	28 mm
Outer Diameter	15 mm
Width	7 mm
d	15 mm
D	28 mm
B	7 mm
d ₁	19.1 mm
d ₂	18.1 mm
D ₁	23.9 mm
r _{1,2} - min.	0.3 mm
r _{3,4} - min.	0.15 mm
a	9.1 mm
d _a - min.	17 mm
d _b - min.	17 mm
D _a - max.	26 mm
D _b - max.	27.2 mm
r _a - max.	0.3 mm
r _b - max.	0.15 mm
d _n	20 mm
Basic dynamic load rating - C	3 kN
Basic static load rating - C ₀	1.3 kN
Fatigue load limit - P _u	0.057 kN
Limiting speed for grease	68000 r/min



UNF BRAINGS SALES JAPAN CO.,LTD.

Lubrication	
Limiting speed for oil lubrication	106000 mm/min
Ball - D_w	3.969 mm
Ball - z	12
G_{ref}	0.2 cm ³
Calculation factor - e	0.68
Calculation factor - Y_2	0.87
Calculation factor - Y_0	0.38
Calculation factor - X_2	0.41
Calculation factor - Y_1	0.92
Calculation factor - Y_2	1.41
Calculation factor - Y_0	0.76
Calculation factor - X_2	0.67
Preload class A - G_A	28 N
Preload class B - G_B	84 N
Preload class C - G_C	170 N
Calculation factor - f	1.04
Calculation factor - f_1	0.99
Calculation factor - f_{2A}	1
Calculation factor - f_{2B}	1.04
Calculation factor - f_{2C}	1.07
Calculation factor - f_{HC}	1
Preload class A	34 N/micron
Preload class B	51 N/micron
Preload class C	66 N/micron
d_1	19.1 mm
d_2	18.1 mm
D_1	23.9 mm
$r_{1,2}$ min.	0.3 mm



UNF BRAINGS SALES JAPAN CO.,LTD.

$r_{3,4}$ min.	0.15 mm
d_a min.	17 mm
d_b min.	17 mm
D_a max.	26 mm
D_b max.	27.2 mm
r_a max.	0.3 mm
r_b max.	0.15 mm
d_n	20 mm
Basic dynamic load rating C	3.02 kN
Basic static load rating C_0	1.34 kN
Fatigue load limit P_u	0.057 kN
Attainable speed for grease lubrication	68000 r/min
Attainable speed for oil-air lubrication	106000 r/min
Ball diameter D_w	3.969 mm
Number of balls z	12
Reference grease quantity G_{ref}	0.2 cm ³
Preload class A G_A	28 N
Static axial stiffness, preload class A	34 N/ μ m
Preload class B G_B	84 N
Static axial stiffness, preload class B	51 N/ μ m
Preload class C G_C	170 N
Static axial stiffness, preload class C	66 N/ μ m
Calculation factor f	1.04
Calculation factor f_1	0.99
Calculation factor f_{2A}	1
Calculation factor f_{2B}	1.04
Calculation factor f_{2C}	1.07
Calculation factor f_{HC}	1



UNF BRAINGS SALES JAPAN CO.,LTD.

Calculation factor e	0.68
Calculation factor (single, tandem) Y_2	0.87
Calculation factor (single, tandem) Y_0	0.38
Calculation factor (single, tandem) X_2	0.41
Calculation factor (back-to-back, face-to-face) Y_1	0.92
Calculation factor (back-to-back, face-to-face) Y_2	1.41
Calculation factor (back-to-back, face-to-face) Y_0	0.76
Calculation factor (back-to-back, face-to-face) X_2	0.67
Mass bearing	0.015 kg